

Stormwater plan notes:

Legends:
Existing stormwater pipe line: [dashed line]

1. Alterations & Additions Alfresco:

In general, there is 01 drain proposed for this development, and it is identified as D1

Stormwater connects to proposed/existing Drain D1 through roof gutters and to either existing stormwater pipes and finally to be discharged to existing stormwater pit

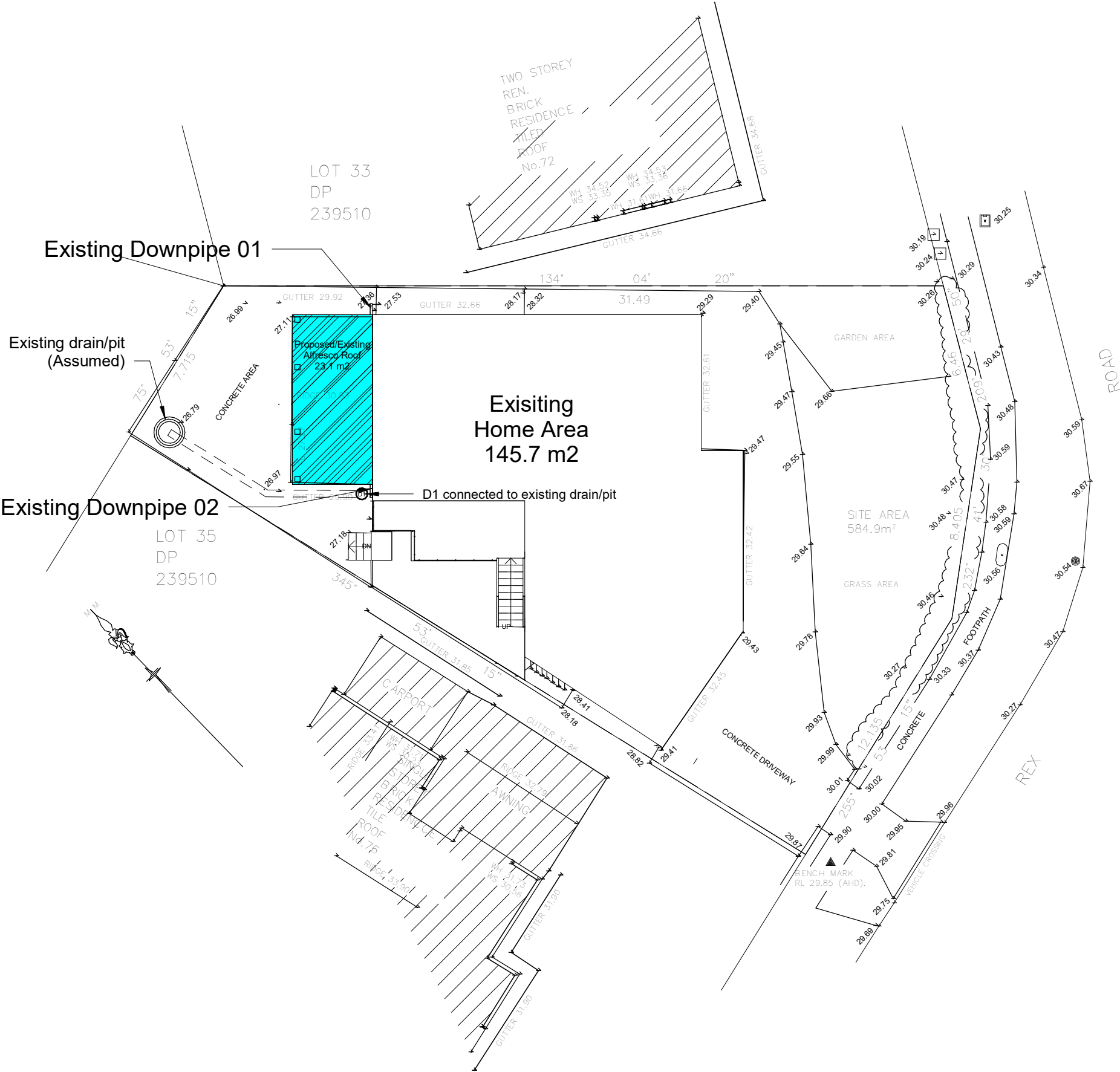

1 Drainage concept plan
A7 1 : 200



TRANTT
architects builder
a: 7/20-26 innesdale rd, wollie creek 2205
e: thai.nguyen@unswalumni.com
m: 0424197188; aia: 61601; lic: 66487s

No.	Description	Issued
1	Issued for Exemption	A

Owner: Deborah Jane Owen

Project address: 74 Rex Road
Georges Hall, NSW 2198, Lot 34, DP239510

Project: Proposed Alfresco

Drainage concept plan

Project number	GH124	A7	Scale	1 : 200
Date	03 Jan 2024			
Drawn by	T. N			
Checked by	T. N			